



## Metal Quick Coupling Valve (QCV)

The Quick Coupling Valve (QCV) is a versatile and robust solution designed to provide quick and easy water access across various irrigation and landscaping projects & available in multiple configurations with durable construction options such as aluminum, brass and red brass. The integrated "Spiral Turn and Lock" key mechanism allows for secure, easy handling, making it ideal for landscape applications.

### HIGHLIGHTS

- **Threaded Inlet Options:** Available in 3/4", 1", 1.25", and 1.5" BSP/NPT female threaded connections, with optional male threaded inlets.
- **Durable Construction:** Made from single and double-piece aluminum or brass/red brass for high resistance to corrosion and wear.
- **Corrosion-Resistant Design:** Featuring a stainless steel spring that prevents leakage, ensuring long-lasting performance.
- **Spiral Turn and Lock Key:** Includes an inbuilt handle design for excellent gripping and ease of use during operation.
- **Enhanced Durability:** Available with thermoplastic covers (black or yellow) and optional locking covers for additional protection and long-term durability.



### APPLICATIONS

- **Irrigation Systems:** Designed for quick installation of Rainguns on riser stands, allowing rapid removal and re-installation on other risers as needed.
- **Landscaping Projects:** Ideal for projects requiring quick water access, particularly in public parks, gardens, and large-scale green areas.
- **Commercial & Agricultural Use:** A high-value solution for both landscaping and agricultural projects, ensuring fast water connection and easy maintenance in large fields and estates.



*Creating a Green World*

# Quick Coupling Valve (Brass / Bronze)



| Flow Rate Range          |  |
|--------------------------|--|
| 3/4" QCV:                | 2.0 to 5.0 m <sup>3</sup> /h             |
| 1" QCV:                  | 4 - 7, 4 - 10 & 6 - 16 m <sup>3</sup> /h |
| 1.5" QCV:                | 10 - 28 m <sup>3</sup> /h                |
| Operating Pressure Range |  |
| 0 to 10 bar              |  |

| Models     | Height (cm) |              |
|------------|-------------|--------------|
|            | QCV         | QCV with Key |
| 70B/BRL    | 10          | 19.2         |
| 70BR/70BRL | 11.5        | 21.1         |
| 71B/BL     | 14          | 24           |
| 71BR/71BRL | 14          | 31.2         |
| 71BT       | 14          | 25.8         |
| 72B        | 15          | 31           |

| Flow Rate<br>(m <sup>3</sup> /hr) | Pressure Loss (Bar) |      |      |      |      |
|-----------------------------------|---------------------|------|------|------|------|
|                                   | 3/4"                | 1"   | 1"   | 1"   | 1.5" |
|                                   |                     | 71BT | 71B  | 71BR |      |
| 2                                 | 0.11                |      |      |      |      |
| 3                                 | 0.25                |      |      |      |      |
| 4                                 | 0.38                | 0.18 | 0.11 |      |      |
| 5                                 | 0.52                | 0.27 | 0.15 |      |      |
| 6                                 |                     | 0.39 | 0.22 | 0.05 |      |
| 7                                 |                     | 0.53 | 0.34 | 0.1  |      |
| 8                                 |                     |      | 0.43 | 0.15 |      |
| 9                                 |                     |      | 0.52 | 0.21 |      |
| 10                                |                     |      | 0.7  | 0.28 | 0.1  |
| 12                                |                     |      |      | 0.41 | 0.13 |
| 14                                |                     |      |      | 0.6  | 0.18 |
| 16                                |                     |      |      | 0.9  | 0.25 |
| 22                                |                     |      |      |      | 0.7  |
| 28                                |                     |      |      |      | 0.95 |



| Models   | QCV Key Descriptions                     |
|----------|--|
| AQ-70BK  | 3/4" Brass QCV Key ( Opener for 70B, BL) |
| AQ-70BRK | 3/4" Bronze QCV Key (for 70BR, BRL)      |
| AQ-71BK  | 1" Brass QCV Key (for 71B, BL)           |
| AQ-71BRK | 1" Bronze QCV Key (for 71BR, BRL)        |
| AQ-71BTK | 1" Brass QCV Key (for 71BT)              |
| AQ-72BK  | 1.5" Bronze QCV Key ( Opener for 72B)    |

| Models   | QCV Descriptions                      |
|----------|---------------------------------------|
| AQ-70B   | 3/4" Brass QCV                        |
| AQ-70BR  | 3/4" Bronze QCV (Rainbird Compatible) |
| AQ-70BL  | Model 70B with Lockable cover         |
| AQ-70BRL | Model 70BR with Lockable cover        |
| AQ-71B   | 1" Brass QCV                          |
| AQ-71BR  | 1" Bronze QCV (Rainbird Compatible)   |
| AQ-71BL  | Model 71B with Lockable cover         |
| AQ-71BRL | Model 71BR with Lockable cover        |
| AQ-71BT  | Model 71B (Toro Compatible)           |
| AQ-72B   | 1.5" Bronze QCV                       |

| S.No. | Description    | Qty |
|-------|----------------|-----|
| 1     | Cap            | 1   |
| 2     | Dowel Pin      | 1   |
| 3     | Groovemate     | 1   |
| 4     | Nut            | 1   |
| 5     | Filter/ Valve  | 1   |
| 6     | Spring         | 1   |
| 7     | Body           | 1   |
| 8     | Insert         | 1   |
| 9     | Sealing Washer | 1   |
| 10    | Bolt           | 1   |

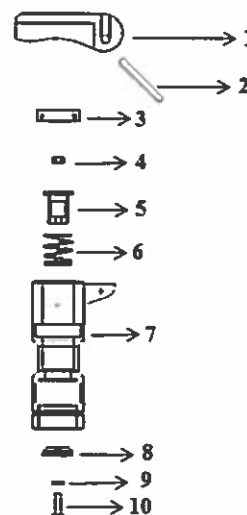

Creating a Green World®

# Double Body Quick Coupling Valve (Bronze)

| Models Description: |   |
|---------------------|---|
| Models              | Product Descriptions                              |
| AQ-70TBR            | 3/4" Red Brass Double Body QCV                    |
| AQ-70TBRL           | 3/4" Red Brass Double body QCV with Locable cover |
| AQ-71TBR            | 1" Red Brass Double Body QCV                      |
| AQ-71TBRL           | 1" Red Brass Double body QCV with Locable cover   |
| AQ-70TBRK           | 3/4" Red Brass QCV Key with MS plated Handle      |
| AQ-71TBRK           | 1" Red Brass QCV Key with MS plated Handle        |

| Material Description |                |                 |     |
|----------------------|----------------|-----------------|-----|
| S. No                | Description    | Material        | Qty |
| 1                    | Dowel Pin      | Stainless Steel | 1   |
| 2                    | Cap            | TPR/TPE         | 1   |
| 3                    | Body Top       | Red Brass       | 1   |
| 4                    | Body Lock Bolt | Stainless Steel | 1   |
| 5                    | Groovemate     | EPDM            | 1   |
| 6                    | Filter         | Brass           | 1   |
| 7                    | Spring         | Stainless Steel | 1   |
| 8                    | Body Bottom    | Red Brass       | 1   |
| 9                    | Rubber Pad     | EPDM & Brass    | 1   |
| 10                   | Sealing Washer | NBR             | 1   |
| 11                   | Filter Bolt    | Stainless Steel | 1   |
| S.No.                | Description    | Material        | Qty |
| 1                    | QCV Key        | Red Brass       | 1   |
| 2                    | Handle         | 1/4" MS Plated  | 1   |

| Flow Rate (m³/hr) | Material Description |      |
|-------------------|----------------------|------|
|                   | 3/4"                 | 1"   |
| 2.3               | 0.15                 |      |
| 4                 | 0.42                 | 0.19 |
| 5                 | 0.62                 | 0.29 |
| 6                 |                      | 0.39 |
| 7                 |                      | 0.52 |

| Flow Rate (m³/hr) | Height (cm) |              |
|-------------------|-------------|--------------|
|                   | QCV         | QCV with Key |
| 70TBR/70TBRL      | 11.1        | 20.1         |
| 71TBR/71TBRL      | 15.2        | 31.3         |

