

Union Ball Valves

PVC & PP

Ball valves are designed to provide reliable and durable performance in various water systems, including field irrigation, nurseries, and greenhouses. Crafted from high-quality PVC & PP materials, it ensures excellent corrosion resistance and user-friendly operation, making it an ideal choice for water distribution systems.

HIGHLIGHTS

- Available in high quality PVC and PP materials.
- Connections – Threaded (BSP, NPT & BSPT) / Solvent Glued Socket end available in ISO, ASTM, BS and DIN standard
- User friendly design allows smooth handle operation with low operational torque.
- Corrosion resistant and UV stabilized.
- Durable, reliable and easy for maintenance.
- Ideal for application in temperature upto 50° C



PVC Ball Valves



PP Ball Valves

APPLICATIONS

- Manual shut-off for distribution lines in irrigation systems.
- Shutoff valve for overhead sprinklers.
- Use as isolation valves.



Technical Data (PVC Ball Valves PN-16 /10)

Nominal Diameter	DN	PN	Connection Type	Connection End	Product Dimensions					
					A		B		C	
					CM	INCH	CM	INCH	CM	INCH
½”	15	16	Single Union	Female Threaded x Female Threaded / Solvent Glued	6	2 ²³ / ₆₄	8.5	3 ¹¹ / ₃₂	8.3	3 ¹⁷ / ₆₄
			Single Union	Male Threaded x Female Threaded	6	2 ²³ / ₆₄	8.5	3 ¹¹ / ₃₂	10	3 ¹⁵ / ₁₆
¾”	20		Single Union	Female Threaded x Female Threaded / Solvent Glued	6	2 ²³ / ₆₄	8.5	3 ¹¹ / ₃₂	8.3	3 ¹⁷ / ₆₄
			Single Union	Male Threaded x Female Threaded	6	2 ²³ / ₆₄	8.5	3 ¹¹ / ₃₂	10	3 ¹⁵ / ₁₆
1”	25		Single Union	Female Threaded x Female Threaded / Solvent Glued	7	2 ³ / ₄	9.5	3 ⁴⁷ / ₆₄	9	3 ³⁵ / ₆₄
			Single Union	Male Threaded x Female Threaded	7	2 ³ / ₄	9.5	3 ⁴⁷ / ₆₄	10.5	4 ⁹ / ₆₄
1¼”	32		Single Union	Female Threaded x Female Threaded / Solvent Glued	10.5	4 ⁹ / ₆₄	11	4 ²¹ / ₆₄	12.3	4 ²⁷ / ₃₂
			Single Union	Male Threaded x Female Threaded	10.5	4 ⁹ / ₆₄	11	4 ²¹ / ₆₄	12.4	4 ⁷ / ₈
1½”	40		Single Union	Female Threaded x Female Threaded / Solvent Glued	12	4 ²³ / ₃₂	13.5	5 ⁵ / ₁₆	13.7	5 ²⁵ / ₆₄
			Single Union	Male Threaded x Female Threaded	12	4 ²³ / ₃₂	13.5	5 ⁵ / ₁₆	13.7	5 ²⁵ / ₆₄
2”	50		Single Union	Female Threaded x Female Threaded / Solvent Glued	15	5 ²⁹ / ₃₂	15.5	6 ⁷ / ₆₄	16.5	6 ¹ / ₂
			Single Union	Male Threaded x Female Threaded	15	5 ²⁹ / ₃₂	15.5	6 ⁷ / ₆₄	16.5	6 ¹ / ₂
2½”	65	10	Single Union	Female Threaded x Female Threaded / Solvent Glued	16	6 ¹⁹ / ₆₄	17.5	6 ⁵⁷ / ₆₄	19	7 ³¹ / ₆₄
			Single Union	Male Threaded x Female Threaded	16	6 ¹⁹ / ₆₄	17.5	6 ⁵⁷ / ₆₄	18	7 ³ / ₃₂
3”	80		Single Union	Female Threaded x Female Threaded / Solvent Glued	20	7 ⁷ / ₈	22.5	8 ⁵⁵ / ₆₄	22.3	8 ²⁵ / ₃₂
			Single Union	Male Threaded x Female Threaded	20	7 ⁷ / ₈	22.5	8 ⁵⁵ / ₆₄	23	9 ¹ / ₁₆
4”	100	100	Single Union	Female Threaded x Female Threaded / Solvent Glued	27	10 ⁵ / ₈	26.5	10 ⁷ / ₁₆	27	10 ⁵ / ₈
			Single Union	Female Threaded x Female Threaded / Solvent Glued	27	10 ⁵ / ₈	26.5	10 ⁷ / ₁₆	27	10 ⁵ / ₈
1”	25	16	Double Union	Female Threaded x Female Threaded / Solvent Glued	7	2 ³ / ₄	10	3 ¹⁵ / ₁₆	11	4 ²¹ / ₆₄
1½”	40		Double Union	Female Threaded x Female Threaded / Solvent Glued	12	4 ²³ / ₃₂	13.5	5 ⁵ / ₁₆	15	5 ²⁹ / ₃₂
2”	50		Double Union	Female Threaded x Female Threaded / Solvent Glued	15	5 ²⁹ / ₃₂	16	6 ¹⁹ / ₆₄	17.5	6 ⁵⁷ / ₆₄
2½”	65		Double Union	Female Threaded x Female Threaded / Solvent Glued	16	6 ¹⁹ / ₆₄	17	6 ¹¹ / ₁₆	21.5	8 ¹⁵ / ₃₂
3”	80	10	Double Union	Female Threaded x Female Threaded / Solvent Glued	20	7 ⁷ / ₈	22.5	8 ⁵⁵ / ₆₄	24.5	9 ⁴¹ / ₆₄
Flanged End Variants										
2½”	65	10	Flanged	Flanged x Flanged	16	6 ¹⁹ / ₆₄	17	6 ¹¹ / ₁₆	23	9 ¹ / ₁₆
3”	80				20	7 ⁷ / ₈	22.5	8 ⁵⁵ / ₆₄	26	10 ¹⁵ / ₆₄

Single Union			
Part No	Part Name	Material	Quantity
1	Ring	PVC	1
2	Socket	PVC	1
3	Small O-ring	NBR	1
4	Bush	PVC	1
5	Big O-ring	NBR	1
6	Seal	TPE	2
7	Body	PVC	1
8	Ball	PVC	1
9	Shaft O-ring	NBR	2
10	Shaft	PVC	1
11	Handle	PPGF	1
12	Handle Logo	PPGF	1

Single Union			
Part No	Part Name	Material	Quantity
1	Ring	PVC	2
2	Socket	PVC	2
3	Small O-ring	NBR	2
4	Bush	PVC	1
5	Big O-ring	NBR	1
6	Seal	TPE	2
7	Body	PVC	1
8	Ball	PVC	1
9	Shaft O-ring	NBR	2
10	Shaft	PVC	1
11	Handle	PPGF	1
12	Handle Logo	PPGF	1

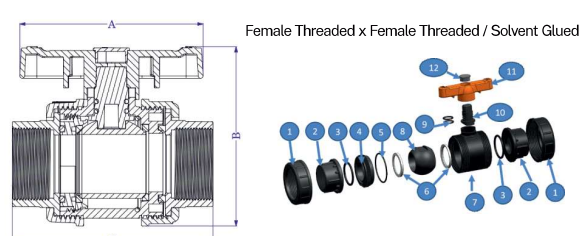
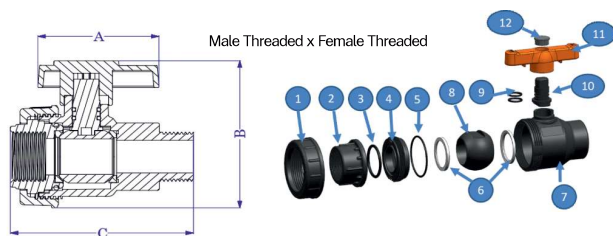

Technical Data (PP Ball Valves PN-6)

Nominal Diameter	DN	PN	Connection Type	Connection End	Product Dimensions					
					A		B		C	
					CM	INCH	CM	INCH	CM	INCH
3/4"	20	6	Single Union	Female Threaded x Female Thread	6	2 ²³ / ₆₄	8.5	3 ¹¹ / ₃₂	8	3 ⁵ / ₃₂
	20		Single Union	Male Threaded x Female Threaded	6	2 ²³ / ₆₄	8.5	3 ¹¹ / ₃₂	9.8	3 ⁵⁵ / ₆₄
1"	25		Single Union	Female Threaded x Female Thread	7	2 ³ / ₄	9.5	3 ⁴⁷ / ₆₄	9	3 ³⁵ / ₆₄
	25		Single Union	Male Threaded x Female Threaded	7	2 ³ / ₄	9.5	3 ⁴⁷ / ₆₄	10.8	4 ¹ / ₄
1 1/4"	32		Single Union	Female Threaded x Female Threaded /Solvent Glued	10.5	4 ⁹ / ₆₄	11	4 ²¹ / ₆₄	12.3	4 ²⁷ / ₃₂
	32		Single Union	Male Threaded x Female Threaded	10.5	4 ⁹ / ₆₄	11	4 ²¹ / ₆₄	12.4	4 ⁷ / ₈
1 1/2"	40		Single Union	Female Threaded x Female Threaded /Solvent Glued	12	4 ²³ / ₃₂	13.2	5 ¹³ / ₆₄	13.5	5 ⁵ / ₁₆
	40		Single Union	Male Threaded x Female Threaded	12	4 ²³ / ₃₂	13.5	5 ⁵ / ₁₆	13.5	5 ⁵ / ₁₆
2"	50		Single Union	Female Threaded x Female Threaded /Solvent Glued	15	5 ²⁹ / ₃₂	15.4	6 ¹ / ₁₆	16.5	6 ¹ / ₂
	50		Single Union	Male Threaded x Female Threaded	15	5 ²⁹ / ₃₂	15.4	6 ¹ / ₁₆	16	6 ¹⁹ / ₆₄
2 1/2"	65		Single Union	Female Threaded x Female Threaded /Solvent Glued	16	6 ¹⁹ / ₆₄	17.8	7 ¹ / ₆₄	19.5	7 ⁴³ / ₆₄
	65		Single Union	Male Threaded x Female Threaded	16	6 ¹⁹ / ₆₄	17.8	7 ¹ / ₆₄	18.5	7 ⁹ / ₃₂
3"	80		Single Union	Female Threaded x Female Threaded /Solvent Glued	20	7 ⁷ / ₈	22.7	8 ¹⁵ / ₁₆	22.2	8 ⁴⁷ / ₆₄
	80		Single Union	Male Threaded x Female Threaded	20	7 ⁷ / ₈	22.7	8 ¹⁵ / ₁₆	23.2	9 ⁹ / ₆₄
4"	100		Single Union	Female Threaded x Female Threaded /Solvent Glued	27	10 ⁵ / ₈	26.3	10 ²³ / ₆₄	26.8	10 ³⁵ / ₆₄
	100		Single Union	Male Threaded x Female Threaded	27	10 ⁵ / ₈	26.3	10 ²³ / ₆₄	27	10 ⁵ / ₈
1"	25		Double Union	Female Threaded x Female Threaded /Solvent Glued	7	2 ³ / ₄	10	3 ¹⁵ / ₁₆	11	4 ²¹ / ₆₄
1 1/2"	40		Double Union	Female Threaded x Female Threaded /Solvent Glued	12	4 ²³ / ₃₂	13.4	5 ⁹ / ₃₂	15	5 ²⁹ / ₃₂
2"	50		Double Union	Female Threaded x Female Threaded /Solvent Glued	15	5 ²⁹ / ₃₂	15	5 ²⁹ / ₃₂	17.5	6 ⁵⁷ / ₆₄
2 1/2"	65		Double Union	Female Threaded x Female Threaded /Solvent Glued	16	6 ¹⁹ / ₆₄	17	6 ¹¹ / ₁₆	20.5	8 ⁵ / ₆₄
3"	80		Double Union	Female Threaded x Female Threaded /Solvent Glued	20	7 ⁷ / ₈	22.7	8 ¹⁵ / ₁₆	24.5	9 ⁴¹ / ₆₄

Single Union			
Part No	Part Name	Material	Quantity
1	Ring	PPGF	1
2	Socket	PPGF/PVC	1
3	Small O-ring	NBR	1
4	Bush	PVC	1
5	Big O-ring	NBR	1
6	Seal	TPE	2
7	Body	PPGF	1
8	Ball	PVC	1
9	Shaft O-ring	NBR	2
10	Shaft	PVC	1
11	Handle	PPGF	1
12	Handle Logo	PPGF	1

Double Union			
Part No	Part Name	Material	Quantity
1	Ring	PPGF	2
2	Socket	PPGF/PVC	2
3	Small O-ring	NBR	2
4	Bush	PVC	1
5	Big O-ring	NBR	1
6	Seal	TPE	2
7	Body	PPGF	1
8	Ball	PVC	1
9	Shaft O-ring	NBR	2
10	Shaft	PVC	1
11	Handle	PPGF	1
12	Handle Logo	PPGF	1

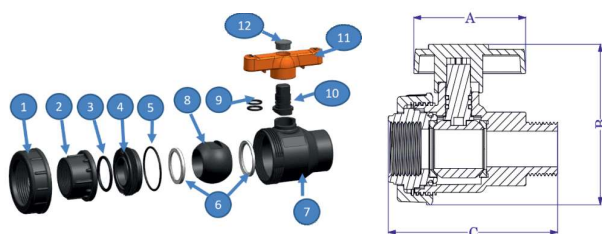

Male Threaded x Female Threaded

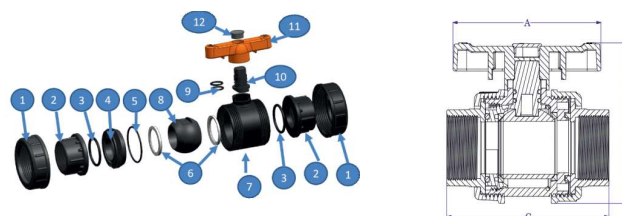

Female Threaded x Female Threaded / Solvent Glued

Technical Data (PP Ball Valves PN-4)

Nominal Diameter	DN	PN	Connection Type	Connection End	Product Dimensions					
					A		B		C	
					CM	INCH	CM	INCH	CM	INCH
	25	4	Single Union	Female Threaded x Female Threaded	7	2 ³ / ₄	9.5	3 ⁴⁷ / ₆₄	9	3 ³⁵ / ₆₄
1"	25		Single Union	Male Threaded x Female Threaded	7	2 ³ / ₄	9.5	3 ⁴⁷ / ₆₄	11	4 ²¹ / ₆₄
1 1/4"	32		Single Union	Female Threaded x Female Threaded / Solvent Glued	10.5	4 ⁹ / ₆₄	11	4 ²¹ / ₆₄	12.3	4 ²⁷ / ₃₂
1 1/2"	40		Single Union	Female Threaded x Female Threaded / Solvent Glued	12	4 ²³ / ₃₂	13	5 ¹ / ₈	13.5	5 ⁵ / ₁₆
2"	50		Single Union	Female Threaded x Female Threaded / Solvent Glued	15	5 ²⁹ / ₃₂	15.5	6 ⁷ / ₆₄	16.5	6 ¹ / ₂
2 1/2"	65		Single Union	Female Threaded x Female Threaded / Solvent Glued	16	6 ¹⁹ / ₆₄	18	7 ³ / ₃₂	19.5	7 ⁴³ / ₆₄
3"	80		Single Union	Female Threaded x Female Threaded / Solvent Glued	20	7 ⁷ / ₈	22.5	8 ⁵⁵ / ₆₄	22	8 ²¹ / ₃₂
1 1/2"	40		Double Union	Female Threaded x Female Threaded / Solvent Glued	12	4 ²³ / ₃₂	13.5	5 ⁵ / ₁₆	15	5 ²⁹ / ₃₂
2"	50		Double Union	Female Threaded x Female Threaded / Solvent Glued	15	5 ²⁹ / ₃₂	15	5 ²⁹ / ₃₂	17.5	6 ⁵⁷ / ₆₄
2 1/2"	65		Double Union	Female Threaded x Female Threaded / Solvent Glued	16	6 ¹⁹ / ₆₄	17	6 ¹¹ / ₁₆	20.5	8 ⁵ / ₆₄
3"	80		Double Union	Female Threaded x Female Threaded / Solvent Glued	20	7 ⁷ / ₈	22.5	8 ⁵⁵ / ₆₄	24.5	9 ⁴¹ / ₆₄

Valve Size: 1"			
Part No	Part Name	Material	Quantity
1	Ring	PP	1
2	Bush	PP	1
3	Main O-ring	NBR	1
4	Seal	TPE	1
5	Ball	PP Compound	1
6	Body	PP	2
7	Shaft	PVC	1
8	Handle	PPGF	1
9	Shaft O-ring	NBR	2

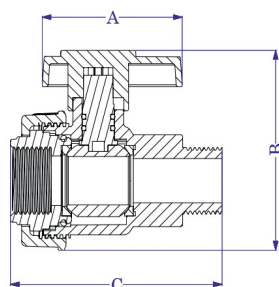

Male Threaded x Female Threaded

Valve Size: 1 1/4" – 3"			
Part No	Part Name	Material	Quantity
1	Ring	PP	1
2	Socket	PP/PVC	1
3	Small O-ring	NBR	1
4	Bush	PPGF	1
5	Big O-ring	NBR	1
6	Seal	TPE	2
7	Body	PP	1
8	Ball	PP compound	1
9	Shaft O-Ring	NBR	2
10	Shaft	PVC	1
11	Handle	PPGF	1
12	Handle Logo	PPGF	1

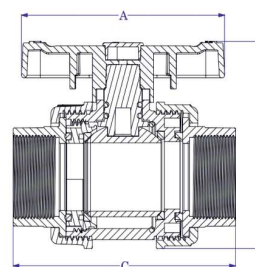
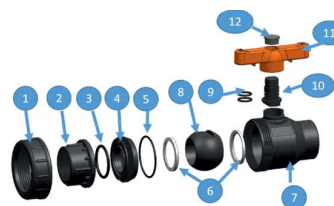

Female Threaded x Female Threaded / Solvent Glued